

Benvenuti Performing Arts Center

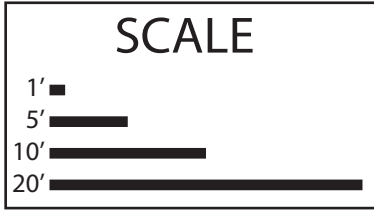
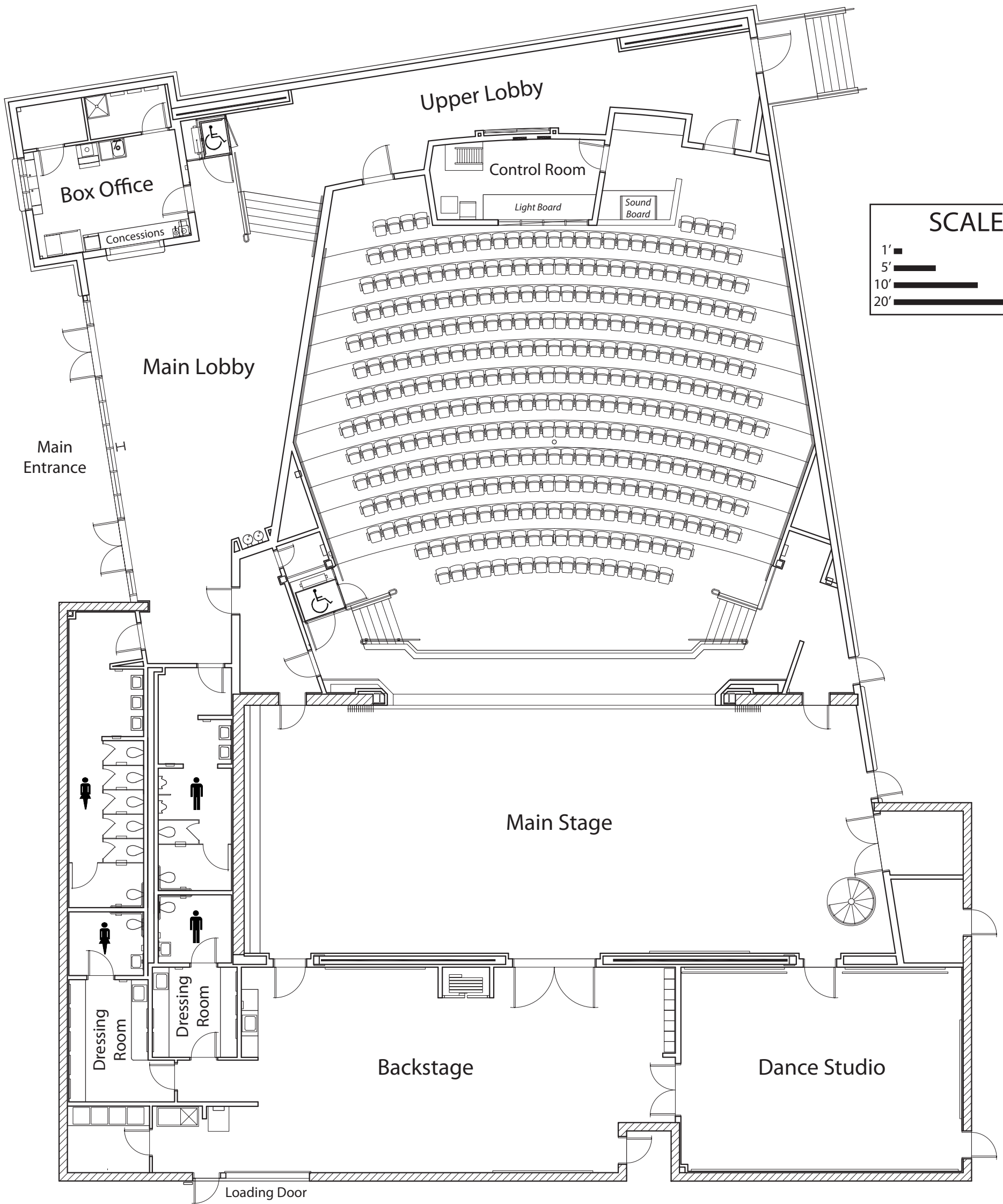

KEY		Theatre Dimensions	
	Wheelchair Lift	Proscenium Arch:	Width 39' - 9"
	Women's Restroom		Height 20'
	Men's Restroom	Center Line to	SL Locking Rail : 33'
	Spot Booth Stairs*		USR Wall : 4'
	Catwalk Stairs*	Plaster Line to	DSR Wall 36'
			Upstage wall : 29' - 6"
		Deck to	DS Edge of Apron : 5' - 9"
			Grid : 40' - 6"
			Gallery (pin rail SR) : 25' - 10"
			Weights Loft : 30'

* Area is off-limits without prior written consent